

**HATCH LEGEND:**

- TURF GRASS SOD = 4,758 S.F.  
INSTALL PER SUPPLIER'S INSTALLATION INSTRUCTIONS.
- LANDSCAPE ROCK = 2,259 S.F.  
PLACE 3" OF 1" - 2" RIVER ROCK OVER COMMERCIAL GRADE WEED FABRIC.

**KEY NOTES:**

- 1 EXISTING TREE.
- 2 EXISTING SHRUB.
- 3 TREES TO BE PLANTED ACCORDING TO TREE PLANTING DETAIL 5.01, SHEET C7.2.
- 4 SHRUBS TO BE PLANTED ACCORDING TO TREE PLANTING DETAIL 5.02, SHEET C7.2.

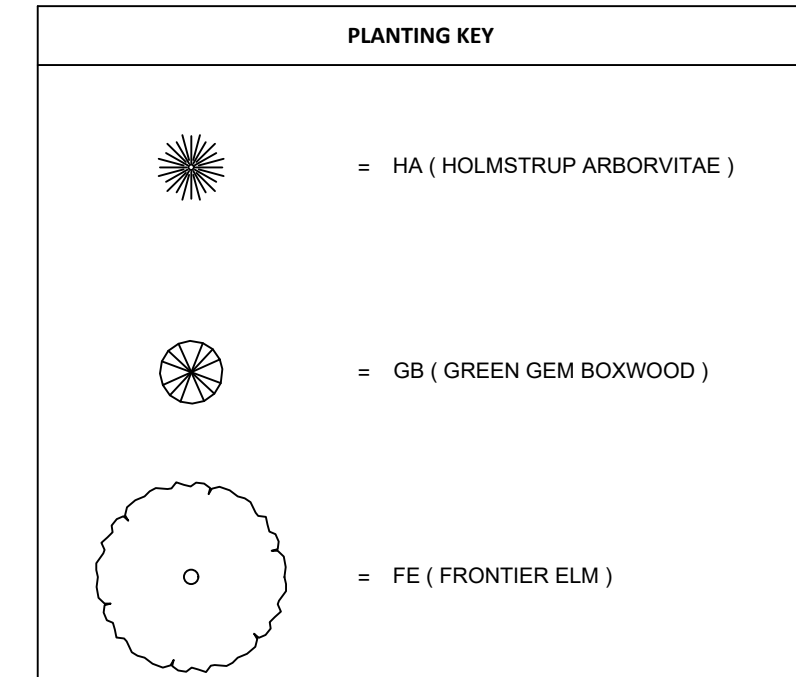

**PLANTING LIST**

TYPE	COMMON NAME (SCIENTIFIC NAME)	QUANTITY REQUIRED	QUANTITY PROVIDED	CONDITION AND SIZE	APPROXIMATE MATURE SIZE
<b>TREES</b>					
		2			
FE	FRONTIER ELM ( ULMUS 'FRONTIER' )		2	2.5" CAL. B&B	25'X30'
<b>SHRUBS</b>					
		31			
HA	HOLMSTRUP ARBORVITAE ( THUJA O. HOLMSTRUP )		20	36" MIN.	6'X3'
GB	GREEN GEM BOXWOOD ( BUXUS 'GREEN GEM' )		11	18" MIN.	3'X3'

**PARKING LOT PERIMETER LANDSCAPING:**

ADDITIONAL SHRUBS HAVE BEEN PROVIDED AROUND THE ADDITIONAL PARKING SPACE IN THE SOUTHEAST CORNER AND ORNAMENTAL GRASS FOR THE ADA STALL IN THE BUILDING ISLAND.

**REFUSE SCREENING LANDSCAPE:**

EVERGREEN SHRUBS HAVE BEEN PLACED AROUND THE TRASH ENCLOSURES FOR SCREENING REQUIREMENTS.

**REPLACEMENT LANDSCAPING:**

TWO TREES HAVE BEEN ADDED TO THE BUILDING ISLAND TO REPLACE THE TREES REMOVED.

FIVE SHRUBS HAVE BEEN ADDED AROUND THE NEW ADA PARKING STALL TO REPLACE THE SHRUBS REMOVED.

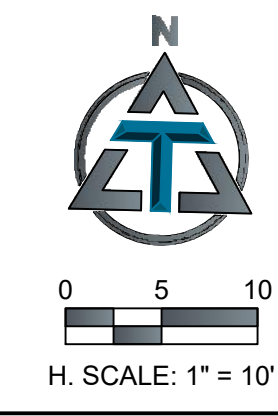

FIRM LICENSE NO. 63620661



ENGINEER OF RECORD:  
NAME: MATTHEW STEVEN MILLER  
LICENSE NO. IL #PE 062 065164

PROJECT NUMBER: 104.100  
REVISION:

7 BREW COFFEE  
ROMEIOVILLE, IL 01  
440 S WEBER RD  
ROMEIOVILLE, IL 60446

**C5.1**  
LANDSCAPE PLAN

DATE: FEBRUARY 27, 2026

S. WEBER ROAD (HIGHWAY 88)  
HERETOFORE DEDICATED  
PUBLIC RIGHT-OF-WAY